

END OR TOP ANCHOR
ANCRE TERMINALE OU SUPÉRIEURE
ENDKONSOLE
ANCLAJE FINAL O SUPERIOR
Description:

The end anchor is equipped with an energy absorber which reduces the force transmitted to the host structure in case a fall. The spring prevents an overloading in case of large temperature variation. The anchor can be fixed directly on a concrete slab or wall. The type of fixing selected will have to be compatible with the calculated forces. The anchor could be attached to the structure with 2 M12 bolts or chemical plugs.

2 End anchors per horizontal lifeline

1 End anchors per Vertical / inclined lifeline

Technical specification:

Delivered with an installer and user manual.

Material: Stainless steel 316

KN 18,5 KN

KN >50 KN

Ø 13 mm

 0,67 Kg

Compliant with EN 795 CLASS C

MADE IN EU 

Test certificate n°AT6495704 

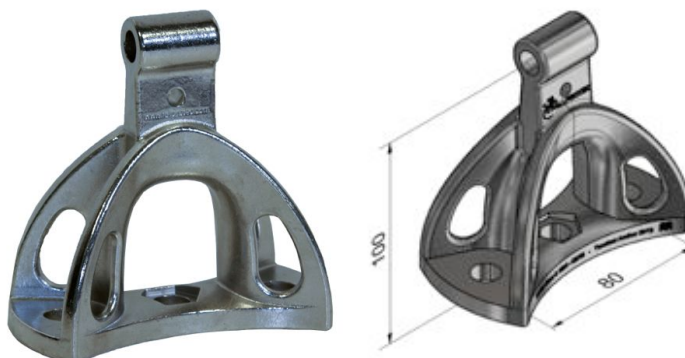
Related devices:

LDV 009



LDV 008



LDV 003



LDV 032

> LDV 009 Front crimping with threaded bar SS304 stanal coating.

> LDV 008 Back crimping lenght 100 mm SS304

For rigid structures (concrete or steel):

> LDV 003 Shock absorber SS304 for lifelines no longer than 20 m.

For fragile structure (cold deck, hot deck, zinc roof, standing seam roof and composite panels):

> LDV 032 Shock absorber with spring syntetic material SS304. For shock absorbing and dilatation compensation.

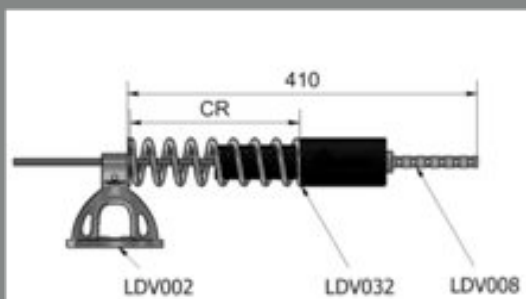
CR

Load: length of spring
 0kg: 200 mm
 50kg: 183 mm
 100kg: 159 mm
 150kg: 141 mm
 200kg: 118 mm
 250kg: 100 mm

Compression
 0mm
 17mm
 41mm
 59mm
 82mm
 100mm

Code N°	Length	Availability
LDV 002	100 x 80 mm	Available from stock



For installations ensure that concrete quality must be at least 25 MPa. LDV 002 must be used in conjunction with other original Securope components. One shock absorber LDV 032 should be assembled per lifeline for installations on fragile structures .