

**SPOTANCHOR**
**SPOTANKER**
**PUNTO DE ANCLAJE SPOTANCHOR**
**Description:**

The anchoring device SpotAnchor is permanently installed on a roof which requires maintenance by people exposed to the risk of falling from height. The anchoring device SpotAnchor consists of a metal body and an anchor plate free to rotate 360°. The assembly is fixed to the structure by a toggle bolt. The waterproofing of the assembly is insured by a PVC or bituminous collar installed at the factory.

Collar is fixed to base plate in factory. Toggle bolt included.

**Technical specification:**

Comes with an installer and user manual.

Mechanical parts: Body in stainless steel and toggle bolt zinc coated or SS304.

**KN** 6 KN

**KN** >12 KN

Ø 32 mm

**Compliant with EN 795 CLASS A**

**MADE IN EU** 

**Certificate of conformity n° 13.6.0197/A**

**Patent LU 92047**

**Related equipment:**

Multipost – SpotAnchor is used in conjunction with the following PPE in accordance with standards EN354, EN355, EN361, EN362.



> HAR 010 Lanyard fitted with absorber.

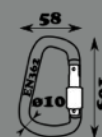

> HAR018 / HAR013 Twist lock carabiner.



> HAR001 Prolight harness.

Code N°	Length	Weight	Collar material	Availability
LDV 049	500 x 500 x 300 mm	2,05 Kg	Bitumen	Available from stock
LDV 052	500 x 500 x 300 mm	2,05 Kg	PVC	Available from stock
LDV 077	205 x 205 x 300 mm	2,00 Kg	Without	Available from stock



The SpotAnchor can be fixed on a concrete slab or wall having strength of 25 MPa or more. Fallprotec certifies that the SpotAnchor was designed for protection of ONE person against falling from height and can work at maximum 2 m around the anchor point. The anchor point and the fixing on the building structure are subject to a force of 6 KN when a fall is stopped. The installer should check that the structure on which the SpotAnchor is fixed is able to withstand the 6 KN force multiplied by a safety coefficient of 2. Prohibited use in case of a storm or other dangerous climatic conditions. The use of an additional safety device used in conjunction with the anchoring device may lead to unsafe situation. Must be inspected by a qualified person at least once a year, as well as after every fall. Do not use any other toggle bolt than the one supplied by Fallprotec. Any modification of or addition to equipment can only be carried out after the prior written agreement of FALLPROTEC.

## Assembly Scheme:

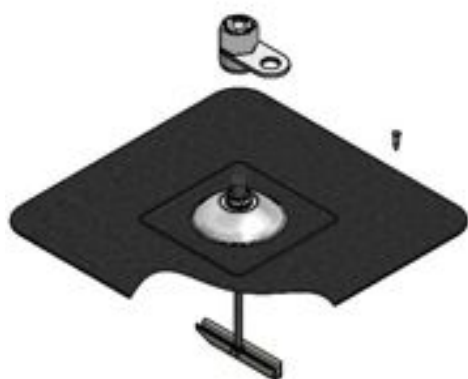

Bituminous membrane

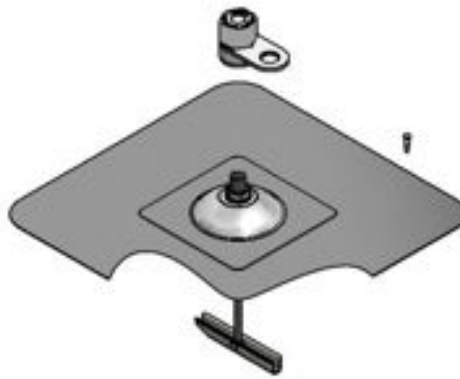

PVC membrane



Without membrane

## LDV 049 SpotAnchor:

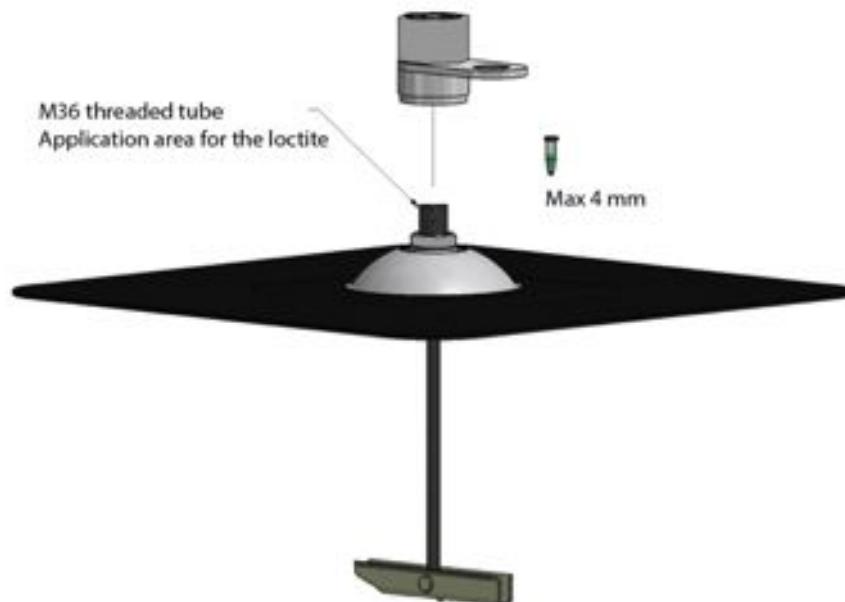

### SPOTANCHOR M12- LDV 043

The anchoring device Spotanchor could be assembled with the NEO anchor LDV 043 as an intermediate. It's already certified by Apave n° AT6495704

